

3D VIEW

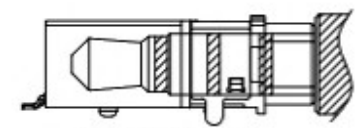

PLUG MATE DRAWING

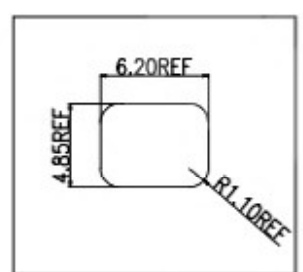
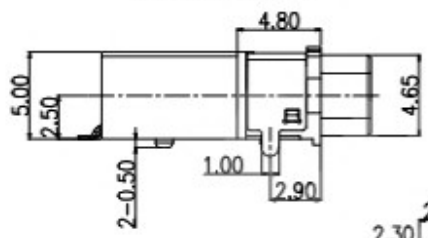

面板开孔参考尺寸

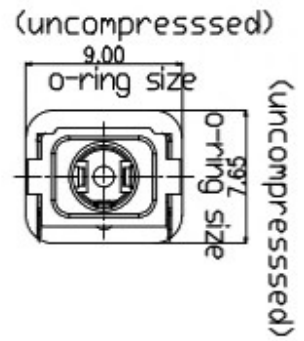
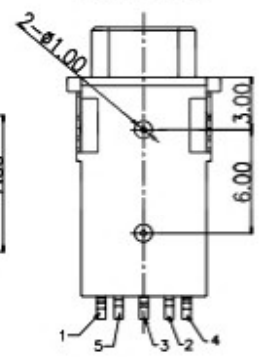
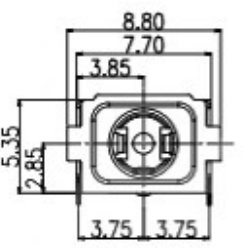
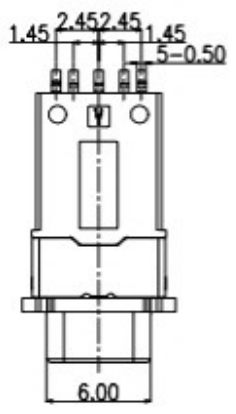

SPECIFICATION:

1. CURRENT RATING:DC 0.5A MAX.
- 2.VOLTAGE RATING:DC 12V.
- 3.CONTACT RESISTANCE:50mΩ MAX.
4. INSULATION RESISTANCE:100MΩ MIN. AT 500V DC.
5. WITHSTANDING VOLTAGE:500V AC FOR 1 MINUTE.
6. LIFE TEST:5000 CYCLES MIN,
7. MATING FORCE:3~30N,
UNMATING FORCE:3~30N.
8. TEPROOF LEVEL:IPX7

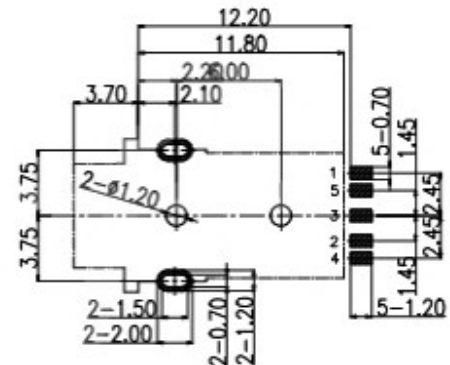

RECOMMENDED P.C.B LAYOUT
TOP VIEW

ITEM	NAME	QTY	DESCRIPTION	NOTE
8	COVER	1	HIGH TEMPERATURE PLASTIC COLOR BLACK	
7	HOUSING	1	HIGH TEMPERATURE PLASTIC COLOR BLACK	
6	SHELL	1	PHOSPHOR BRONZE; NICKEL PLATED OVERALL	
5	TERMINAL 5#	1	PHOSPHOR BRONZE; GOLD FLASH ON CONTACT AREA; GOLD FLASH PLATING ON SOLDER TAIL AREA, ALL OVER NICKEL PLATED	
4	TERMINAL 4#	1	PHOSPHOR BRONZE; GOLD FLASH ON CONTACT AREA; GOLD FLASH PLATING ON SOLDER TAIL AREA, ALL OVER NICKEL PLATED	
3	TERMINAL 3#	1	PHOSPHOR BRONZE; GOLD FLASH ON CONTACT AREA; GOLD FLASH PLATING ON SOLDER TAIL AREA, ALL OVER NICKEL PLATED	
2	TERMINAL 2#	1	PHOSPHOR BRONZE; GOLD FLASH ON CONTACT AREA; GOLD FLASH PLATING ON SOLDER TAIL AREA, ALL OVER NICKEL PLATED	
1	TERMINAL 1#	1	PHOSPHOR BRONZE; GOLD FLASH ON CONTACT AREA; GOLD FLASH PLATING ON SOLDER TAIL AREA, ALL OVER NICKEL PLATED	

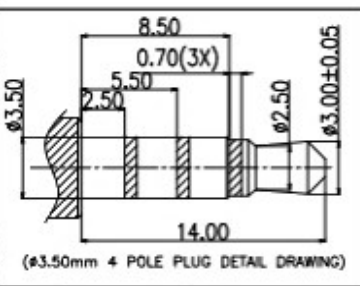
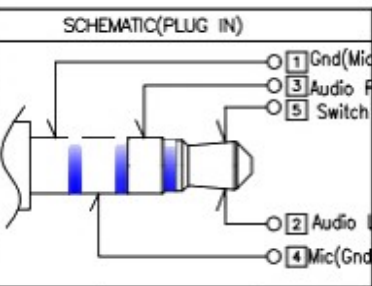
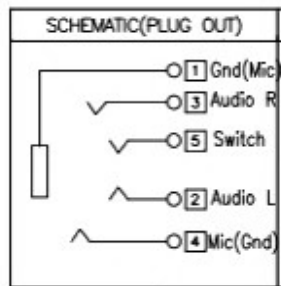

(Ø3.50mm 4 POLE PLUG DETAIL DRAWING)

东莞市溪榜电子有限公司

COPYRIGHT RESERVED,PLEASE DO NOT COPY.

PART NAME		PHONE JACK		DRAWING	Y,C,ZHANG	DWG.No.	SBICL
PART NO.		PJ-611		CHECK	G.C.Chen	REV.	A1
UNIT : mm	TOLERANCE	UP TO 5	±0.2	APPROVAL		DATE	
	OTHERWISE	ABOVE 5 ~ 30	±0.3	SCALE	2:1	PAGE	1 OF 1
		ABOVE 30	±0.5				
		ANGLE	±3				