

电路图

技术参数

- 1: 使用温度范围: -40度至120度
- 2: 额定负荷: DC 30V 0.1A
- 3: 接触电阻: 小于等于0.03欧姆
- 4: 绝缘电阻: 小于等于100欧姆
- 5: 耐压: AC300V(50Hz)/min
- 6: 动作力: 1至3N
- 7: 寿命: 10万次

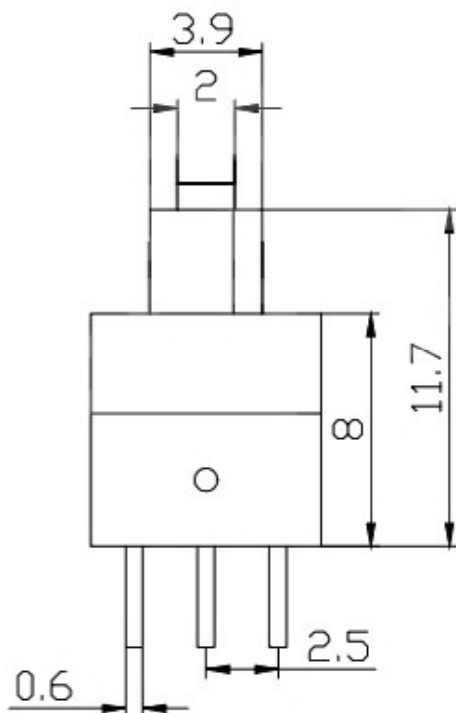
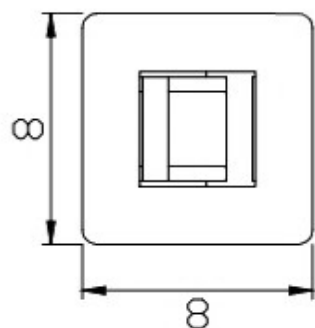

PART NAME		PUSH SWITCH		DRAWING		Y,C,ZHANG	DWG.No.	SBICL
PART NO.				CHECK		G.C.Chen	REV.	A1
	UNIT :	TOLERANCE	UP TO 5	±0.2	ANGLE	APPROVAL		DATE
	mm	OTHERWISE	ABOVE 5~30	±0.3		SCALE	2:1	PAGE
			ABOVE 30	±0.5				
			ANGLE	±3				