

RoHS
Compliant

性能:

额定电流: 3.0A

额定电压: 24V

耐电压: 500V

接触电阻: 30mΩ MAX

绝缘电阻: 500MΩ

工作温度: -40℃~+85℃

塑件(材质): LCP, 耐高温260℃

接触点(材质): 铜合金, 触点镀金3U

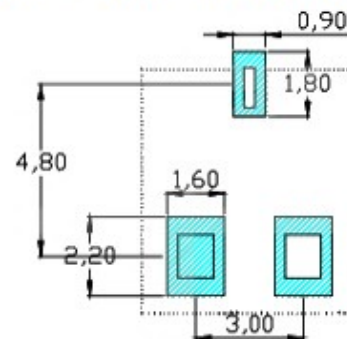
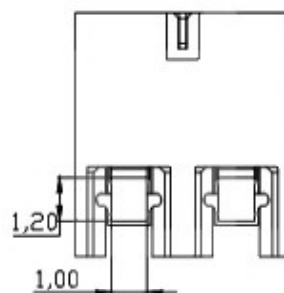
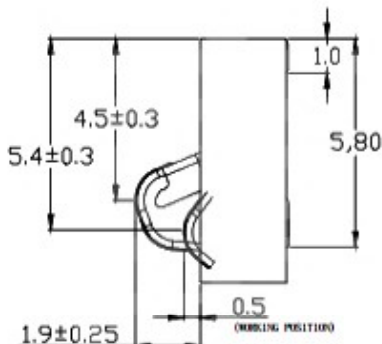
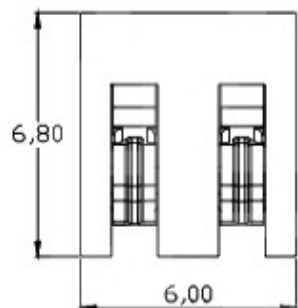
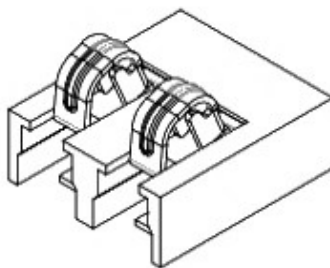
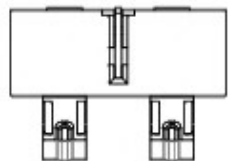

RECOMMENDED PCB LAYOUT
TOP VIEW (.XX±0.05)

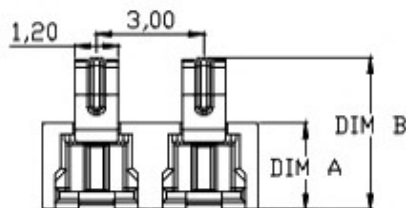

PART NO.	DIM A	DIM B
BC2P30H24-C06	2.4	4.30±0.25
BC2P30H35-C06	3.5	5.40±0.25

 东莞市溪榜电子有限公司

COPYRIGHT RESERVED, PLEASE DO NOT COPY.

PART NAME		CONNECTOR		DRAWING		Y,C,ZHANG		DWG.No.		SBICL	
PART NO.				CHECK		G.C.Chen		REV.		A1	
UNIT : mm	TOLERANCE OTHERWISE	UP TO 5	±0.2	ANGLE	APPROVAL			DATE			
		ABOVE 5~30	±0.3								