

性能:

额定电流: 2.0A
 额定电压: 12V
 耐电压: 500V
 接触电阻: 30mΩ
 绝缘电阻: 500MΩ
 工作温度: -40℃~+85℃
 塑件(材质): LCP 黑色
 接触点(材质): 铜合金

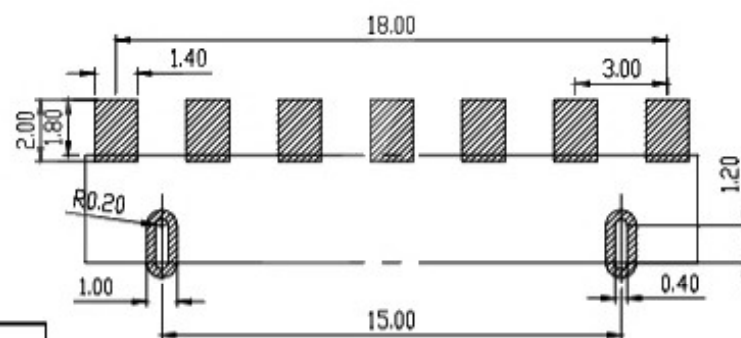
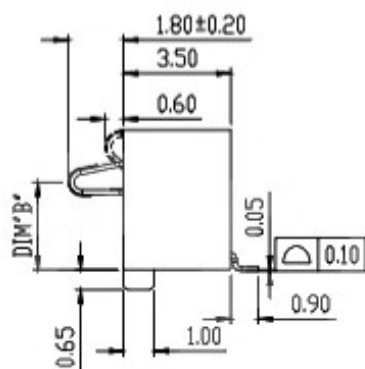
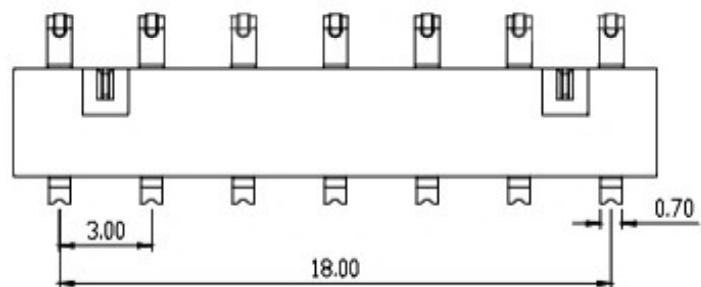
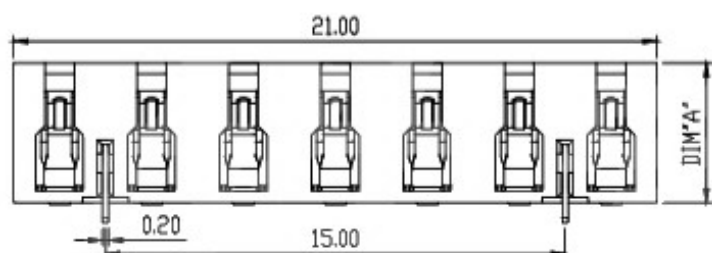
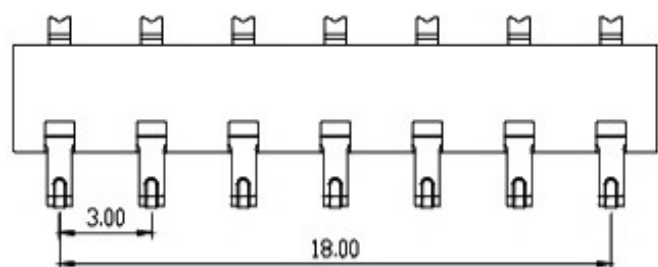

RECOMMENDED PCB LAYOUT
 TOL:(±0.05)

规格型号	DIM A	DIM B
BC7P30H72-C06	7.2	5.6
BC7P30H65-C06	6.5	4.9
BC7P30H50-C06	5.0	3.4
BC7P30H46-C06	4.6	3.0

PART NAME		CONNECTOR		DRAWING	Y.C,ZHANG	DWG.No.	SBICL
PART NO.				CHECK	G.C.Chen	REV.	A1
UNIT : mm	TOLERANCE OTHERWISE	UP TO 5 ABOVE 5~30 ABOVE 30 ANGLE	±0.2 ±0.3 ±0.5 ±3°	APPROVAL		DATE	
				SCALE	2:1	PAGE	1 OF 1