

性能:

额定电流: 1.0A
 额定电压: 12V
 耐电压: 500V
 接触电阻: 30mΩ MAX
 绝缘电阻: 500MΩ
 工作温度: -40℃~+85℃
 塑件(材质): LCP E130I
 接触点(材质): 铜合金, 触点镀金15μ

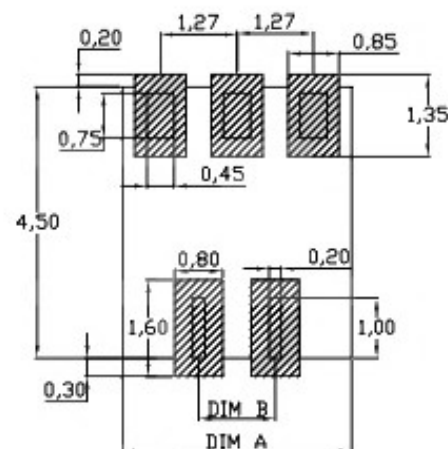

RECOMMENDED PCB LAYOUT
 TOP VIEW (.XX±0.05)

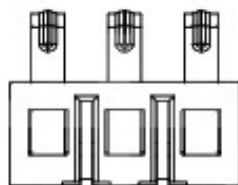
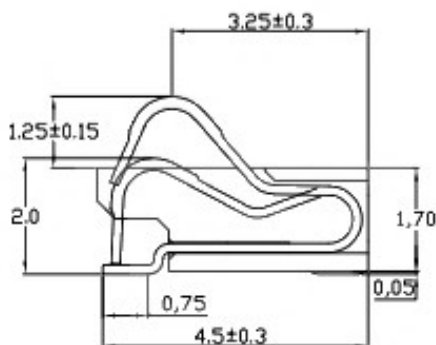
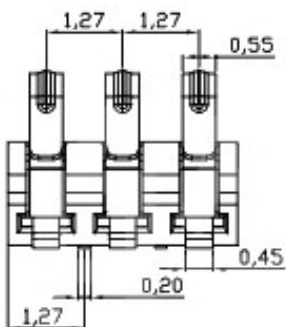
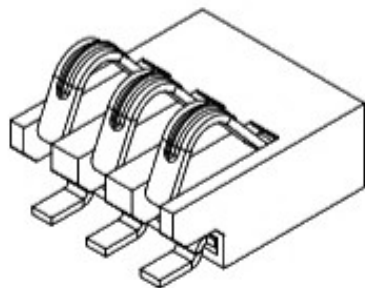
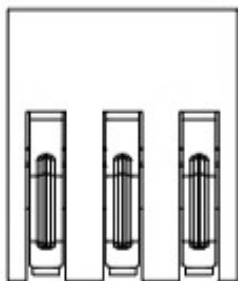
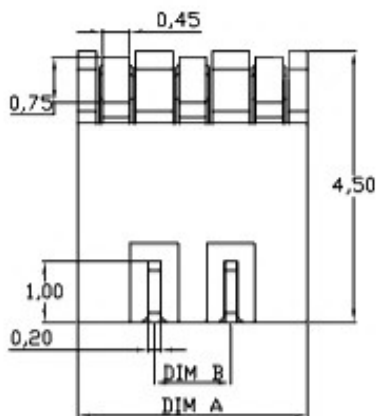

PART NO.	DIM A	DIM B
BC2P127H17	2.54	
BC3P127H17	3.81	1.27
BC4P127H17	5.08	2.54
BC5P127H17	6.35	3.81
BC6P127H17	7.62	5.08

PART NAME		CONNECTOR		DRAWING	Y,C,ZHANG	DWG.No.	SBICL
PART NO.				CHECK	G.C.Chen	REV.	A1
UNIT : mm	TOLERANCE	UP TO 5	±0.2	APPROVAL		DATE	
	OTHERWISE	ABOVE 5 ~30	±0.3				
		ABOVE 30	±0.5	SCALE	2:1	PAGE	1 OF 1
		ANGLE	±.7				