

SPECIFICATIONS:

1. ELECTRICAL CHARACTERISTICS:

- 1-1. CONTACT RESISTANCE: 30mΩ MAX.
- 1-2. DIELECTRIC WITHSTANDING VOLTAGE: 100V AC FOR ONE MINUTE.
- 1-3. INSULATION RESISTANCE: 100M ΩMIN. MEASURED BY 500 VDC

2. MECHANICAL CHARACTERISTICS:

- 2-1. INSERTION FORCE :0.5-2.0KgF(REF.)
- 2-2. WITHDRAWAL FORCE :0.8-2.0KgF(REF.)

3. LIFE TEST: 5,000 CYCLES.

4. TO CONFORM TO THE KRCONN HAZARDOUS SUBSTANCE FREE SPEC.

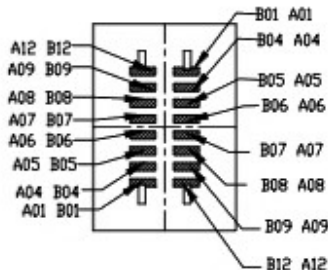
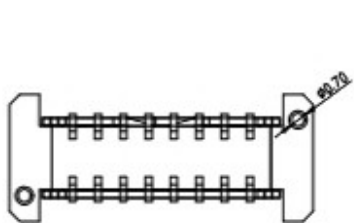
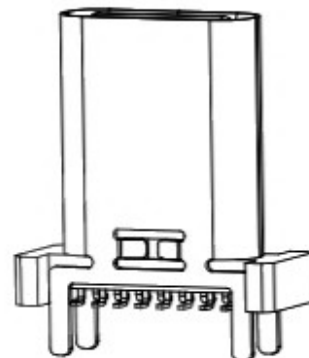
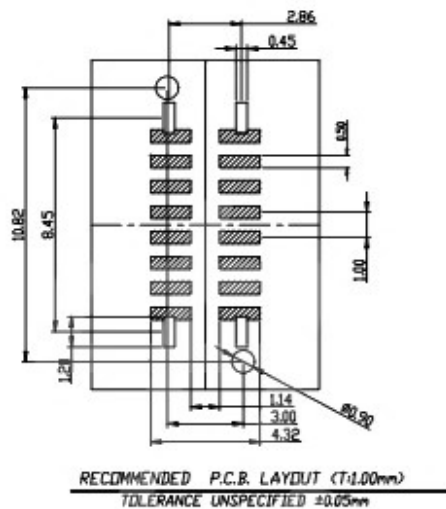
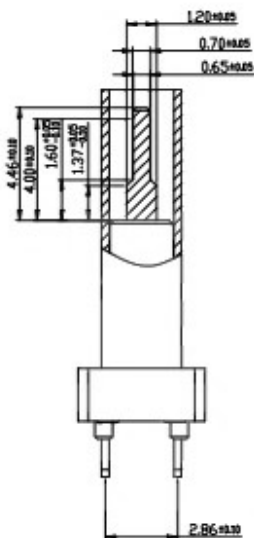
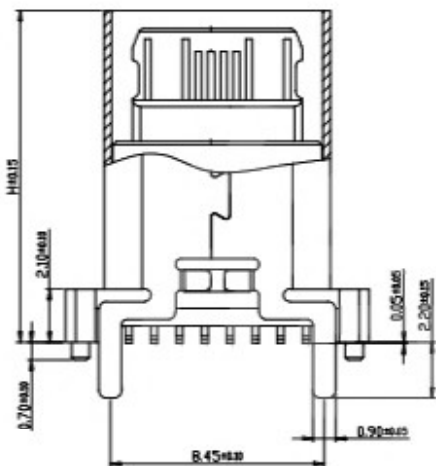
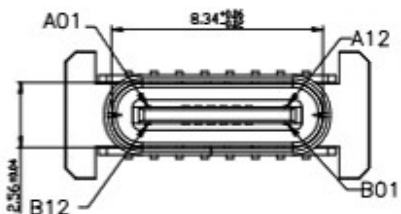

A1	GN0	B02	GN0
A4	VBUS	B9	VBUS
A5	CC1	B8	SBUS2
A6	DP1	B7	DN2
A7	DN	B6	DP2
A8	SBUS1	B5	CC2
A9	VBUS	B4	VBUS
A12	GN0	B1	GN0
PIN	SIGNAL NAME	PIN	SIGNAL NAME

6	SHELL	STAINLESS STEEL	Ni Plated	SPCS
5	SHIELDING PLATE	STAINLESS STEEL	---	SPCS
4	MD	HIGH TEMPERATURE PLASTIC	BLACK	SPCS
3	CONTACT	COPPER ALLOY	Au/Ni Plated	ISET
2	CONTACT	COPPER ALLOY	Au/Ni Plated	ISET
1	HOUSING	HIGH TEMPERATURE PLASTIC	BLACK	SPCS
NO.	DESCRIPTION	MATERIAL	REMARKS	QTY

H= MM	
9.30	10.00
10.50	12.40
13.10	13.70
15.00	17.50

PART NAME	CONNECTOR	DRAWING	Y,C,ZHANG	DWG.No.	SBICL
PART NO.	TYPE-C SERIES	CHECK	G.C.Chen	REV.	A1
UNIT : mm	TOLERANCE	UP TO 5	±0.2	ANGLE	APPROVAL
	OTHERWISE	ABOVE 5 ~ 30	±0.3	0°±3'	SCALE
		ABOVE 30	±0.5		2:1
		ANGLE	±3'		PAGE
					1 OF 1