

RECOMMENDED P.C.B.*LAYOUT

Specifications

Rating: DC 12V/50mA
 Contact Resistance: 500mΩ max
 Insulation resistance: DC100V 60S 100MΩ min
 Dielectric strength: AC250V(50~60HZ)60S min
 Operation force: 160±30gf 180±30gf 240±50gf
 Operating Life: 300,000cycles 100,00cycles
 Travels: 0.13±0.05mm

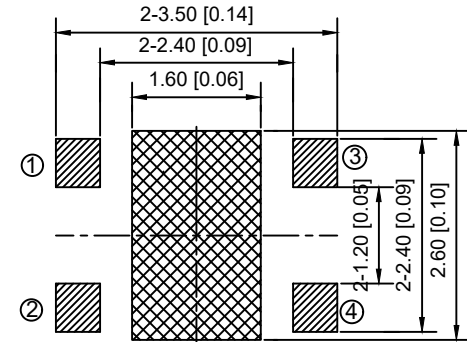

LAND PATTERN PLAN

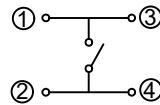
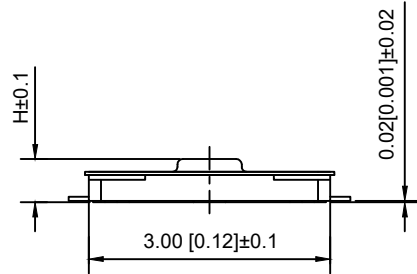

CIRCUIT DIAGRAM

PAPT NO	TS-2630-X
Operating Force	B:160gf C:260gf
Height	H:0.65

ITEM	PART NAME	QUANTITY	MATERIAL	FINISH
5	KNOB	1	POLYAMIDE	BLACK
4	FILM	1	POLYAMIDE	WHITE
3	DOME	2	STAINLESS STEEL	Ag-PLATED
2	HOUSING	1	POLYAMIDE	BLACK
1	TERMINAL	1	PHOSPHOR BRONZE	Ag-PLATED

DSND		DATE		SCALE: N/A	MODEL TYPE: TACT SWITCH
DWN		DATE		VIEW:	PART NO.:
CHKD		DATE		UNIT: mm/in	DWG NO.: TS-2630-X
APPD		DATE		SIZE: A4	WEIGHT 1.0g
DONG GUAN XI BANG ELECTRONIC CO., LTD					SHEET 1/1
					REVISION A0

MARK	DESCRIPTION	DATE	REVISED	APPROVED	units: mm	tolerance:
ΔX					X.X	±0.2mm
ΔX					X.XX	±0.1mm
ΔX					X.XXX	±0.05mm
REVISIONS						UNSPECIFIED TOLERANCES
www.alpsr.com www.gdxjdz.com www.xbswitch.com						