

下压5.6mm 达到锁定行程

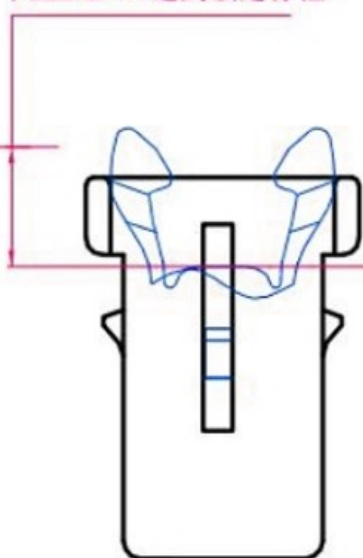

回弹1.1mm 呈锁住状态

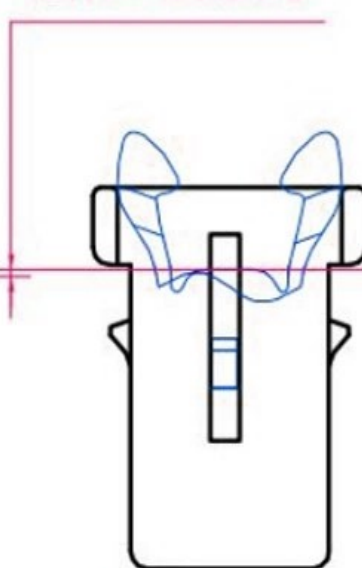

继续下压1.1mm 即达到开锁行程

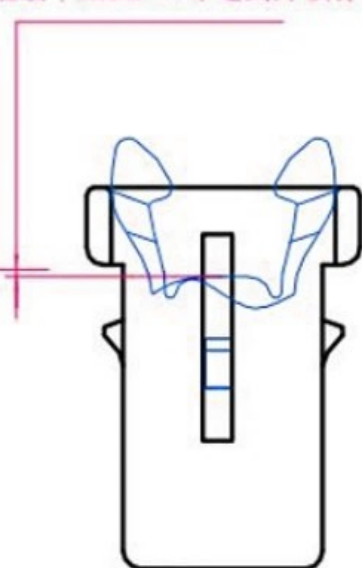

锁舌参考尺寸

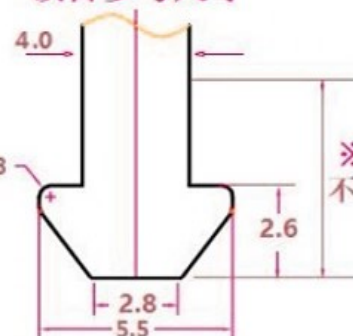

※ 两侧必须做倒角 R0.3

※ 锁舌长度
不得短于5.8mm

外壳: POM
 按键: PA66
 弹簧: SUS304
 钩针: SUS304
 脱钩力: 20N

※ 注: 锁舌厚度或者直径不能大于5.7mm

TITLE	DOOR LATCH SWITCH	DRAWN	TOLERANCE OTHERWISE UNLESS SPECIFIED	8				
PART NO.		CHECKED	UP TO 5	±0.2	6			
DRAW NO.	DL1	APPROVED	ABOVE 5 ~ 30	±0.3	5			
SCALE: 2:1	UNIT: mm	DATE:	ABOVE 30 ~ 50	±0.4	4			
			ABOVE 50	±0.5	3	SPRING	SUS	1 NI PLATED
			ANGLE	±3°	2	HOUSING	POM	1 BLACK
					1	SLIDER	PA12	1 BLACK
					NO.	PARTS	MATERIAL	QTY. FINISHING